

# MISC. BODY, CHASSIS ACCESSORIES

## GROUP

**22**

**FROM PAGE 469 THRU 480**

### INDEX OF MISC. BODY, CHASSIS, ACCESSORIES SUB-GROUPS

NO. SUB GROUP	PARTS IN SUB GROUP	PAGE
2201	Rear View Mirror.....	470-471
2202	Identification and Caution Plates.....	471
2203	Speedometer Parts.....	472
2204	Spot Light (Ambulance).....	473
	Heater Parts.....	473
	Accessories (Radio).....	474
2205	Radio Noise Suppression Parts.....	475-476-477-478
2206	Model T214 Weapon Carrier Conversion Package.....	479
2207	Gun Mounting Parts—Model T214.....	479
2210	Oil Can Bracket.....	479
	Rifle Bracket Assembly and Parts—Model T223.....	480

# MISC. BODY, CHASSIS ACCESSORIES—GROUP 22

REAR VIEW MIRROR—SUB-GROUP 2201								
YEAR AND ENGINEERING SYMBOL	BODY STYLE	Rear View Mirror ARM to Cowl Screw To Plate	Rear View MIR-ROR Ass'y Inside	Rear View ROR Ass'y Outside	Rear View Mirror ARM Outside	Rear View Mirror Arm Hinge PIN	Rear View Mirror Arm BRA'KT	Rear View Mirror Arm Locking PLATE
		1 Req'd	1 Req'd	1 Req'd	1 Req'd	1 Req'd	1 Req'd	1 Req'd
1940—T202	UP TO SERIAL NO. 8643462 CLOSED CAB—PICK-UP	☆	889087	747184	797317	797331	☆	☆
	OPEN CAB—PICK-UP	☆	890175	747184	797317	797331	☆	☆
	RADIO, RECONNAISSANCE	☆	890175	747184	797317	797331	☆	☆
	AFTER SERIAL NO. 8643462 CLOSED CAB—PICK-UP	☆	889087	747184	890248	797331	☆	☆
	OPEN CAB—PICK-UP	☆	890175	747184	890248	797331	☆	☆
	RADIO, RECONNAISSANCE	☆	890175	747184	890248	797331	☆	☆
	CARRY-ALL	☆	889087	747184	890248	797331	☆	☆
1940—T203	ALL EXCEPT AMBULANCE	☆	889087	747184	873999	797331	☆	☆
	AMBULANCE	☆	889087	747184	890248	797331	☆	☆
1941—T207	CLOSED CAB—PICK-UP	☆	889087	747184	903144	797331	☆	☆
	OPEN CAB—PICK-UP	☆	890175	747184	903144	797331	☆	☆
	RADIO RECONNAISSANCE	☆	890175	747184	903144	797331	☆	☆
	CARRY-ALL, PANEL	☆	889087	747184	903144	797331	☆	☆
	AMBULANCE	☆	889087	747184	873999	797331	☆	☆
1941—T211	CLOSED CAB—PICK-UP	☆	889087	919385	919231	919235	919233	919234
	OPEN CAB—PICK-UP	☆	920650	919385	919231	919235	919233	919234
	RADIO, RECONNAISSANCE	☆	920650	919385	919231	919235	919233	919234
	CARRY-ALL	☆	889087	919385	919231	919235	919233	919234
	PANEL	☆	919237	919385	919231	919235	919233	919234
	AMBULANCE	☆	889087	919385	919231	919235	919233	919234
1941—T215	CLOSED CAB—PICK-UP	☆	920680	920311	919231	919235	919233	919234
	OPEN CAB—PICK-UP	☆	920650	920311	919231	919235	919233	919234
	RADIO, RECONNAISSANCE	☆	920650	920311	919231	919235	919233	919234
	CARRY-ALL TELEPHONE	☆	920680	920311	919231	919235	919233	919234
	AMBULANCE	☆	920680	920311	919231	919235	919233	919234
1941—T112	ALL EXCEPT CARRY-ALL	☆	586915	747184	890251	919235	☆	☆
	CARRY-ALL	☆	889087	747184	797317	919235	☆	☆
1941—T118	UP TO SERIAL NO. 81334245	☆	889087	747184	890251	797331	☆	☆
	AFTER SERIAL NO. 81334245	☆	901091	747184	890251	950428	☆	☆
1942—T214	WEAPON CARRIER	☆	950932	920312	991399	919235	950931	☆
	RADIO, RECONNAISSANCE	☆	950932	920312	991399	919235	950931	☆
	CARRY-ALL	☆	920680	920312	919230	919235	919233	919234
	AMBULANCE	☆	920680	920312	919230	919235	919233	919234
1943—T223	PERSONNEL AND CARGO	950729	950932	920312	SEE NOTE 1	☆	950931	☆

☆ Not Used

## NOTE 1

- |  |
|--|
| 1—991399—Rear View Mirror Arm Assembly (Less Brackets) |
| 1—950929—Rear View Mirror Arm Assembly (With Brackets) |

# MISC. BODY, CHASSIS ACCESSORIES—GROUP 22

## REAR VIEW MIRROR—SUB-GROUP 2201

<p><b>(INSIDE) REAR VIEW MIRROR ATTACHING PARTS TO HEADER PANEL ON CLOSED CAB—CARRY-ALL PANEL—AMBULANCE</b></p> <p>ALL MODELS</p> <p>2 Req'd—Part No. 134422 BOLT                  2 Req'd—Part No. 120392 PLAINWASHER                  2 Req'd—Part No. 120380 LOCKWASHER                  2 Req'd—Part No. 134551 NUT</p>	<p><b>(INSIDE) REAR VIEW MIRROR ATTACHING PARTS MODEL T223</b></p> <p>2—106692 SCREW (To Windshield)                  2—131420 NUT                  2—174916 LOCKWASHER</p>																																																																																																
<p><b>TO WINDSHIELD ON RADIO—RECONNAISSANCE</b></p> <p>1940—T202    2 Req'd—Part No. 134422 BOLT                  2 Req'd—Part No. 120392 PLAINWASHER                  2 Req'd—Part No. 120380 LOCKWASHER                  2 Req'd—Part No. 134551 NUT</p>	<p>Rear View Mirror Arm to Hinge SCREW AND LOCKWASHER</p> <p>ALL MODELS EXCEPT T214</p> <p>1 Req'd—Part No. 123473 SCREW                  1 Req'd—Part No. 120214 LOCKWASHER</p> <p>T214</p> <p>1 Req'd—Part No. 123473 SCREW                  1 Req'd—Part No. 178532 LOCKWASHER</p>																																																																																																
<p>1941—T207    2 Req'd—Part No. 133053 BOLT                  1941—T211    2 Req'd—Part No. 120392 PLAINWASHER                  2 Req'd—Part No. 120380 LOCKWASHER                  1941—T215    2 Req'd—Part No. 134551 NUT</p>	<p>Tapping PLATE (Cowl Rear View Mirror Arm)</p> <p>T214—RADIO—RECONNAISSANCE WEAPON CARRIER AND GUN MOTOR CARRIAGE</p> <p>1 Req'd—Part No. 950729 PLATE</p>																																																																																																
<p>1942—T214    2 Req'd—Part No. 120706 BOLT                  2 Req'd—Part No. 120392 PLAINWASHER                  2 Req'd—Part No. 174916 LOCKWASHER                  2 Req'd—Part No. 131593 NUT</p>	<p><b>IDENTIFICATION AND CAUTION PLATES—SUB-GROUP 2202</b></p>																																																																																																
<p><b>TO WINDSHIELD ON OPEN CAB—WEAPON CARRIER—GUN MOTOR CARRIAGE</b></p> <p>1940—T202    2 Req'd—Part No. 134422 BOLT                  2 Req'd—Part No. 120392 PLAINWASHER                  2 Req'd—Part No. 120380 LOCKWASHER                  2 Req'd—Part No. 134551 NUT</p>	<table border="1"> <thead> <tr> <th>No. Req'd</th> <th>Part No.</th> <th>Part Name</th> </tr> </thead> <tbody> <tr> <td colspan="3" style="text-align: center;"><b>MODELS T202-T203</b></td> </tr> <tr> <td>1</td> <td>615808</td> <td>Serial Number PLATE</td> </tr> <tr> <td>2</td> <td>144791</td> <td>SCREW (Serial Number Plate)</td> </tr> <tr> <td>2</td> <td>144791</td> <td>SCREW (Speed Caution Plate)</td> </tr> <tr> <td colspan="3" style="text-align: center;"><b>MODEL T207</b></td> </tr> <tr> <td>1</td> <td>615808</td> <td>Serial Number PLATE</td> </tr> <tr> <td>2</td> <td>136028</td> <td>RIVET (Serial Number Plate)</td> </tr> <tr> <td>2</td> <td>144791</td> <td>SCREW (Speed Caution Plate)</td> </tr> <tr> <td>2</td> <td>136028</td> <td>RIVET (Speed Caution Plate)</td> </tr> <tr> <td>4</td> <td>136028</td> <td>RIVET (Winch Speed Caution Plate)</td> </tr> <tr> <td colspan="3" style="text-align: center;"><b>MODEL T211</b></td> </tr> <tr> <td>1</td> <td>615808</td> <td>Serial Number PLATE</td> </tr> <tr> <td>2</td> <td>136028</td> <td>RIVET (Serial Number Plate)</td> </tr> <tr> <td>2</td> <td>144791</td> <td>SCREW (Speed Caution Plate)</td> </tr> <tr> <td colspan="3" style="text-align: center;"><b>MODEL T215</b></td> </tr> <tr> <td>1</td> <td>615808</td> <td>Serial Number PLATE</td> </tr> <tr> <td>2</td> <td>136028</td> <td>RIVET (Serial Number Plate)</td> </tr> <tr> <td>2</td> <td>125675</td> <td>SCREW (Maintenance Number Plate)</td> </tr> <tr> <td>2</td> <td>144791</td> <td>SCREW (Speed Caution Plate)</td> </tr> <tr> <td>2</td> <td>136028</td> <td>RIVET (Speed Caution Plate)</td> </tr> <tr> <td>2</td> <td>144791</td> <td>SCREW (Winch Speed Caution Plate)</td> </tr> <tr> <td colspan="3" style="text-align: center;"><b>MODELS T112-T118</b></td> </tr> <tr> <td>1</td> <td>615808</td> <td>Serial Number PLATE</td> </tr> <tr> <td>2</td> <td>144791</td> <td>SCREW (Serial Number Plate)</td> </tr> <tr> <td colspan="3" style="text-align: center;"><b>MODEL T214</b></td> </tr> <tr> <td>1</td> <td>615808</td> <td>Serial Number PLATE</td> </tr> <tr> <td>2</td> <td>136028</td> <td>RIVET (Serial Number Plate)</td> </tr> <tr> <td>2</td> <td>142385</td> <td>SCREW (Maintenance Number Plate)</td> </tr> <tr> <td>2</td> <td>142385</td> <td>SCREW (Speed Caution Plate)</td> </tr> <tr> <td>2</td> <td>136028</td> <td>RIVET (Speed Caution Plate)</td> </tr> <tr> <td>4</td> <td>136028</td> <td>RIVET (Winch Speed Caution Plate)</td> </tr> </tbody> </table>	No. Req'd	Part No.	Part Name	<b>MODELS T202-T203</b>			1	615808	Serial Number PLATE	2	144791	SCREW (Serial Number Plate)	2	144791	SCREW (Speed Caution Plate)	<b>MODEL T207</b>			1	615808	Serial Number PLATE	2	136028	RIVET (Serial Number Plate)	2	144791	SCREW (Speed Caution Plate)	2	136028	RIVET (Speed Caution Plate)	4	136028	RIVET (Winch Speed Caution Plate)	<b>MODEL T211</b>			1	615808	Serial Number PLATE	2	136028	RIVET (Serial Number Plate)	2	144791	SCREW (Speed Caution Plate)	<b>MODEL T215</b>			1	615808	Serial Number PLATE	2	136028	RIVET (Serial Number Plate)	2	125675	SCREW (Maintenance Number Plate)	2	144791	SCREW (Speed Caution Plate)	2	136028	RIVET (Speed Caution Plate)	2	144791	SCREW (Winch Speed Caution Plate)	<b>MODELS T112-T118</b>			1	615808	Serial Number PLATE	2	144791	SCREW (Serial Number Plate)	<b>MODEL T214</b>			1	615808	Serial Number PLATE	2	136028	RIVET (Serial Number Plate)	2	142385	SCREW (Maintenance Number Plate)	2	142385	SCREW (Speed Caution Plate)	2	136028	RIVET (Speed Caution Plate)	4	136028	RIVET (Winch Speed Caution Plate)
No. Req'd	Part No.	Part Name																																																																																															
<b>MODELS T202-T203</b>																																																																																																	
1	615808	Serial Number PLATE																																																																																															
2	144791	SCREW (Serial Number Plate)																																																																																															
2	144791	SCREW (Speed Caution Plate)																																																																																															
<b>MODEL T207</b>																																																																																																	
1	615808	Serial Number PLATE																																																																																															
2	136028	RIVET (Serial Number Plate)																																																																																															
2	144791	SCREW (Speed Caution Plate)																																																																																															
2	136028	RIVET (Speed Caution Plate)																																																																																															
4	136028	RIVET (Winch Speed Caution Plate)																																																																																															
<b>MODEL T211</b>																																																																																																	
1	615808	Serial Number PLATE																																																																																															
2	136028	RIVET (Serial Number Plate)																																																																																															
2	144791	SCREW (Speed Caution Plate)																																																																																															
<b>MODEL T215</b>																																																																																																	
1	615808	Serial Number PLATE																																																																																															
2	136028	RIVET (Serial Number Plate)																																																																																															
2	125675	SCREW (Maintenance Number Plate)																																																																																															
2	144791	SCREW (Speed Caution Plate)																																																																																															
2	136028	RIVET (Speed Caution Plate)																																																																																															
2	144791	SCREW (Winch Speed Caution Plate)																																																																																															
<b>MODELS T112-T118</b>																																																																																																	
1	615808	Serial Number PLATE																																																																																															
2	144791	SCREW (Serial Number Plate)																																																																																															
<b>MODEL T214</b>																																																																																																	
1	615808	Serial Number PLATE																																																																																															
2	136028	RIVET (Serial Number Plate)																																																																																															
2	142385	SCREW (Maintenance Number Plate)																																																																																															
2	142385	SCREW (Speed Caution Plate)																																																																																															
2	136028	RIVET (Speed Caution Plate)																																																																																															
4	136028	RIVET (Winch Speed Caution Plate)																																																																																															
<p>1941—T207    2 Req'd—Part No. 123473 SCREW                  1941—T211    2 Req'd—Part No. 120214 LOCKWASHER                  1941—T215</p>	<p>Rear View Mirror Mounting NUT AND LOCKWASHER</p> <p>ALL MODELS</p> <p>1 Req'd—Part No. 131657 NUT                  1 Req'd—Part No. 120380 LOCKWASHER</p>																																																																																																
<p>1942—T214    2 Req'd—Part No. 134422 BOLT                  2 Req'd—Part No. 120392 PLAINWASHER                  2 Req'd—Part No. 174916 LOCKWASHER                  2 Req'd—Part No. 131593 NUT</p>	<p>Rear View Mirror Hinge Pin NUT AND LOCKWASHER</p> <p>MODELS T211-T215-T112-T118</p> <p>1 Req'd—Part No. 134551 NUT                  1 Req'd—Part No. 120380 LOCKWASHER</p> <p>MODEL T214</p> <p>1 Req'd—Part No. 134551 NUT                  1 Req'd—Part No. 174916 LOCKWASHER</p>																																																																																																
<p><b>(OUTSIDE) REAR VIEW MIRROR ATTACHING PARTS</b></p> <p>Rear View Mirror Mounting NUT AND LOCKWASHER</p> <p>ALL MODELS</p> <p>1 Req'd—Part No. 131657 NUT                  1 Req'd—Part No. 120380 LOCKWASHER</p>	<p>Rear View Mirror Arm Mounting Bracket SCREW AND LOCKWASHER</p> <p>MODELS T211-T215</p> <p>2 Req'd—Part No. 123473 SCREW                  2 Req'd—Part No. 120214 LOCKWASHER</p> <p>MODEL T214</p> <p>2 Req'd—Part No. 123473 SCREW                  2 Req'd—Part No. 178532 LOCKWASHER</p> <p>MODEL T223</p> <p>2 Req'd—Part No. 121661 SCREW                  4 Req'd—Part No. 178532 LOCKWASHER</p>																																																																																																



# MISC. BODY, CHASSIS ACCESSORIES—GROUP 22

## SPEEDOMETER PARTS—SUB-GROUP 2203

USM-MISC-1

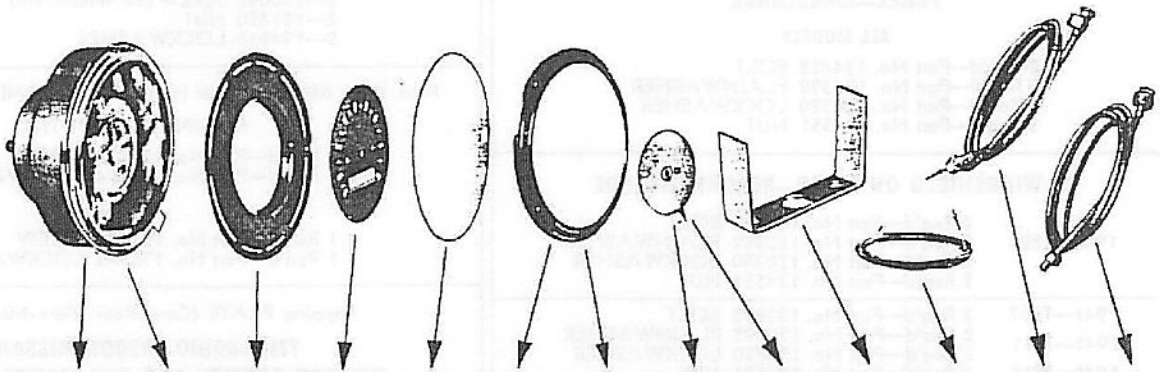

YEAR AND ENGINEERING SYMBOL	SPEEDOMETER Assembly		Speed-ometer Face DIAL	Speed-ometer Face PLATE	Speed-ometer LENS	Speedometer BEZEL		Speed POINTER		Speed-ometer Mount'g BRA'KT	Speed-ometer CABLE Ass'y (Drive Shaft)	Speed-ometer CABLE and HOUS-ING Ass'y	Speed-ometer Cable HOUS-ING
	Bright Finish	Painted Finish				Bright Finish	Painted Finish	Painted Red (Used with Bright Finish Ass'y)	Painted White (Used with Painted Finish Ass'y)				
	SEE NOTE 1	SEE NOTE 1				SEE NOTE 1	SEE NOTE 1						
	1 Req'd	1 Req'd				1 Req'd	1 Req'd	1 Req'd	1 Req'd				
1940—T202	595361	923714	597915	599670	589883	597914	923713	589890	923712	☆	595367	NOT SERVICED	595368
1940—T203	595361	923714	597915	599670	589883	597914	923713	589890	923712	☆	Serviced in Assembly	SEE NOTE 2	Serviced in Assembly
1941—T207	595361	923714	597915	599670	589883	597914	923713	589890	923712	☆	595367	NOT SERVICED	595368
1941—T211	595361	923714	597915	599670	589883	597914	923713	589890	923712	☆	595367	NOT SERVICED	595368
1941—T215	☆	923860	SERVICED IN SPEEDOMETER ASSEMBLY						919908	595367	NOT SERVICED	595368	
1941—T112	595361	923714	597915	599670	589883	597914	923713	589890	923712	☆	595367	NOT SERVICED	595368
1941—T118	595361	923714	597915	599670	589883	597914	923713	589890	923712	☆	595367	NOT SERVICED	595368
1942—T214 Telephone Maintenance and Installation Emergency Repair Chassis All Except Carry-All and Ambulance	☆	923860	SERVICED IN SPEEDOMETER ASSEMBLY						919908	920402	SEE NOTE 3	595371	
1942—T214 Telephone Maintenance and Installation Emergency Repair Chassis Carry-All and Ambulance	☆	923860	SERVICED IN SPEEDOMETER ASSEMBLY						919908	Serviced in Assembly	920404	Serviced in Assembly	
1943—T223	☆	923860	SERVICED IN SPEEDOMETER ASSEMBLY						919908	926080	NOT SERVICED	926081	

**NOTE 1**

☆ Not Used

Painted Finish Speedometer Assembly, Bezel, and Pointer (Painted White) May be Used When Stock of Bright Finish Speedometer Assembly, Bezel, and Pointer (Painted Red) is Not Available At Army Depots.

NOTE: Bright Finish was Used In Production on T202-T203, T207-T211 and T112 Up To Serial No. 81,113,001 and T118 Up To Serial No. 81,334,245. Painted Finish was Used In Production On T112 After Serial No. 81,113,001 and On T118 After Serial No. 81,334,245.

**NOTE 2**

For T203 Models With Winch Specify Part No. 599211 CABLE and HOUSING Assembly.  
For T203 Models Less Winch Specify Part No. 597936 CABLE and HOUSING Assembly.

**NOTE 3**

NOTE: When Stock At Army Depots is Not Available On 920402 CABLE and 595371 HOUSING (67" Long) Part No. 920404 CABLE AND HOUSING Assembly (70" Long) May Be Used.

☆ CURRENT NUMBER—FOR PREVIOUS NUMBER, SEE PARTS SUPERSEDECE LIST.

# MISC. BODY, CHASSIS ACCESSORIES — GROUP 22

## SPOTLIGHT—AMBULANCE—SUB-GROUP 2204

## HEATER PARTS—SUB-GROUP 2204

USM-MISC-2

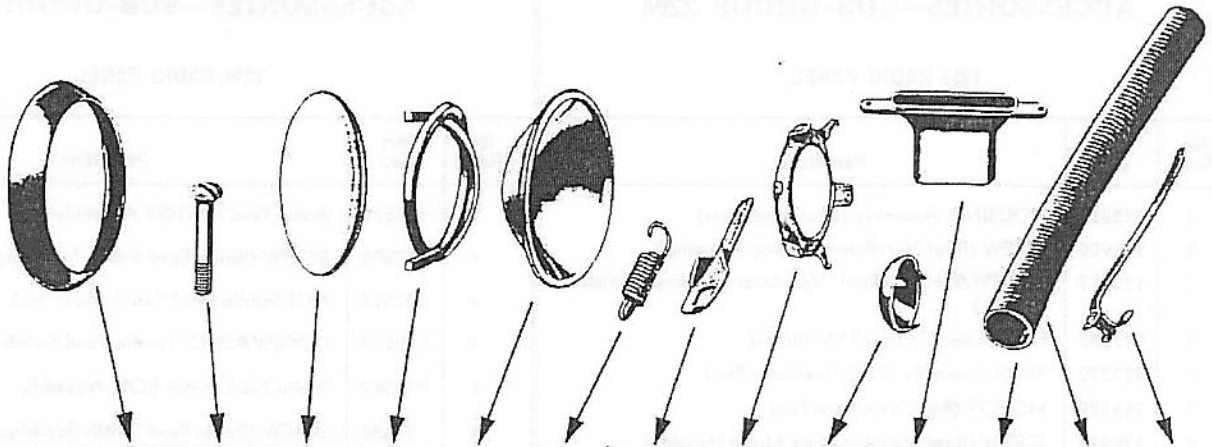

YEAR AND ENGINEERING SYMBOL	Spotlight DOOR	Spotlight Door SCREW	Spotlight LENS	Spotlight Lens GASK'T	Spotlight RE-FLEC'R	Spotlight Reflector SPRING	Spotlight Reflector Spring GRIP	Spotlight Reflector Pressure PLATE	Spotlight Bulb CAP	Heater Defroster NOZZLE	Heater Defroster TUBE		Heater Defroster CLAMP Ass'y
											Right	Left	
	1 Req'd	1 Req'd	1 Req'd	1 Req'd	1 Req'd	3 Req'd	3 Req'd	1 Req'd	2 Req'd	4 Req'd	1 Req'd	1 Req'd	2 Req'd
1940—T202	☆	☆	☆	☆	☆	☆	☆	☆	☆	☆	☆	☆	☆
1940—T203	☆	☆	☆	☆	☆	☆	☆	☆	☆	683299	698519	684049	683302
1941—T207	946953	946954	794088	689853	689854	689856	689857	689855	689858	683299	698519	684049	683302
1941—T211	946953	946954	794088	689853	689854	689856	689857	689855	689858	683299	698519	684049	683302
1941—T215	946953	946954	794088	689853	689854	689856	689857	689855	689858	683299	698519	684049	683302
1941—T112	☆	☆	☆	☆	☆	☆	☆	☆	☆	☆	☆	☆	☆
1941—T118	☆	☆	☆	☆	☆	☆	☆	☆	☆	☆	☆	☆	☆
1942—T214	946953	946954	794088	689853	689854	689856	689857	689855	689858	683299	698519	684049	683302

☆ Not Used

For Radio Panel Parts peculiar to Model T215, see Page 474

# MISC. BODY, CHASSIS ACCESSORIES — GROUP 22

ACCESSORIES—SUB-GROUP 2204			ACCESSORIES—SUB-GROUP 2204		
T215 RADIO PANEL			T215 RADIO PANEL		
No. Req'd	Part No.	Part Name	No. Req'd	Part No.	Part Name
1	923328	HOUSING Assembly (Roof Ventilator)	1	922519	Radio Feed SWITCH Assembly
3	132900	SCREW (Roof Ventilator Housing Mounting)	4	132908	SCREW (Radio Feed Switch Mounting)
3	120217	LOCKWASHER (Roof Ventilator Housing Mounting Screw)	4	120614	NUT (Radio Feed Switch Mounting)
1	923335	FAN Assembly (Roof Ventilator)	4	120217	LOCKWASHER (Radio Feed Switch Mounting Screw)
1	923330	RING Assembly (Roof Ventilator Fan)	1	922517	Radio Feed Switch BOX Assembly
1	923329	MOTOR (Roof Ventilator Fan)	4	51680	SCREW (Radio Feed Switch Box Mounting)
2	132915	SCREW (Roof Ventilator Fan Motor Housing)	4	120380	LOCKWASHER (Radio Feed Switch Box Mounting Screw)
2	120614	NUT (Roof Ventilator Fan Motor Mounting Screw)	1	121879	SCREW (Radio Feed Switch Box Ground Terminal)
2	178378	LOCKWASHER (Roof Ventilator Fan Motor Mounting Screw)	1	134551	NUT (Radio Feed Switch Box Ground Terminal Screw)
1	923331	CONDENSER (Roof Ventilator Fan Motor Radio Interference)	1	174916	LOCKWASHER (Radio Feed Switch Box Ground Terminal Screw)
1	923332	SCREEN (Roof Ventilator Fan)	1	923727	FILTER Assembly (Radio Interference)
1	923333	Regulator GRILLE Assembly (Roof Ventilator Fan)	4	120367	NUT (Radio Interference Filter Mounting)
4	134239	SCREW (Mounting) (Roof Ventilator Fan Regulator Grille to Ventilator)	8	174916	LOCKWASHER (Radio Interference Filter Mounting Nut)
1	79498	SWITCH Assembly (Roof Ventilator Fan)	6	121540	SCREW (Radio Interference Filter Terminal)
2	132688	SCREW (Mounting) (Roof Ventilator Fan Switch)	6	120217	LOCKWASHER (Radio Interference Filter Terminal Screw)
2	138473	LOCKWASHER (Roof Ventilator Fan Switch Screw)			<b>T214 RADIO</b>
1	923324	WIRING Assembly (Roof Ventilator Fan and Dome Lamp)	1	924715	FILTER Assembly (Radio Interference)
1	114038	TERMINAL (Roof Ventilator Fan and Dome Lamp Wiring)	4	120368	NUT (Radio Interference Mounting)
8	120910	SCREW (Mounting) (Roof Ventilator)	4	178532	LOCKWASHER (Radio Interference Mounting Nut)
8	120361	NUT (Mounting Screw) (Roof Ventilator)	6	121540	SCREW (Radio Interference Terminal)
8	178378	LOCKWASHER (Mounting Screw) (Roof Ventilator)	6	120217	LOCKWASHER (Radio Interference Terminal Screw)
		<b>T214 AMBULANCE</b>	1	673228	CONDENSER
1	924079	SWITCH Assembly (Roof Ventilator Fan)			
2	132696	SCREW (Mounting) (Roof Ventilator Fan Switch)			
2	138473	LOCKWASHER (Mounting Screw) (Roof Ventilator Fan)			



# MISC. BODY, CHASSIS ACCESSORIES—GROUP 22

PAGE 475

## RADIO NOISE SUPPRESSION PARTS—SUB-GROUP 2205

Quan. Req'd	Part No.	Name of Part	Quan. Req'd	Part No.	Name of Part
		<b>GROUND STRAP</b> T202 RADIO EQUIPPED			<b>T214 WEAPON CARRIER AND GUN MOTOR CARRIAGE</b>
1	913318	GROUND STRAP—Steering Column to Dash	1	923861	GROUND STRAP—Body to Cab
1	913319	GROUND STRAP—Controls	1	926053	GROUND STRAP—Body Cross Sill to Frame
1	599918	GROUND STRAP—Engine	1	923720	GROUND STRAP—Steering Column to Instrument Panel
		T207 RADIO EQUIPPED			<b>SCREWS</b>
1	913318	GROUND STRAP—Steering Column to Dash			<b>T214 RADIO NOISE SUPPRESSION PARTS</b>
1	913319	GROUND STRAP—Controls	2	123499	SCREW—Oil Filter to Bracket ( $\frac{3}{16}$ "—24 x $1\frac{1}{8}$ ")
1	599918	GROUND STRAP—Engine	2	126358	SCREW—Steering Column Grounding ( $\frac{3}{16}$ "—18 x 1")
		T211 RADIO EQUIPPED	2	120918	SCREW—Clutch Housing to Cylinder Block—Upper ( $\frac{3}{4}$ "—16 x $1\frac{1}{2}$ ")
1	913318	GROUND STRAP—Steering Column to Dash	4	156963	SCREW—Front Door Outside Handle (No. 10—24 x $\frac{1}{2}$ ") (Ambulance and Carry-All)
1	913319	GROUND STRAP—Controls	2	156963	SCREW—Rear Door Outside Handle (No. 10—24 x $\frac{1}{2}$ ") (Ambulance)
1	599918	GROUND STRAP—Engine	2	156963	SCREW—Tail Gate Lock Handle—Attaching (No. 10—24 x $\frac{1}{2}$ ") (Reconnaissance and Carry-All)
		T215 RADIO EQUIPPED	4	188192	SCREW—Terminal Box—Attaching ( $\frac{1}{4}$ "—28 x $\frac{3}{8}$ ") (Reconnaissance and Carry-All)
1	913318	GROUND STRAP—Steering Column to Dash	1	120228	SCREW—Crankcase Ventilator Outlet Pipe Clamp ( $\frac{3}{16}$ "—18 x $\frac{3}{8}$ ")
1	913319	GROUND STRAP—Controls	1	122119	SCREW—Crankcase Ventilator Outlet Pipe Bracket to Cylinder Block ( $\frac{3}{8}$ "—16 x $\frac{3}{4}$ ")
1	922518	GROUND STRAP—Engine to Frame Side Rail	4	123499	SCREW—Oil Filter to Bracket ( $\frac{3}{16}$ "—24 x $1\frac{1}{8}$ ")
1	122119	Ground Strap BOLT—Engine End	4	122017	SCREW—Fan Blade ( $\frac{3}{16}$ "—18 x 1")
2	178571	Ground Strap Grounding WASHER—Engine to Frame Side Rail (Engine End)	1	870846	SCREW—Left Front Splash Shield to Frame Ground Strap
2	178551	Ground Strap Grounding WASHER—Engine to Frame Side Rail (Fender End)	2	120217	SCREW—Body Cross Sill to Frame Ground Strap ( $\frac{3}{16}$ "—18 x 1") (Weapon Carrier and Gun Motor Carriage)
1	922537	GROUND STRAP—Steering Column and Coil to Dash	1	120741	SCREW—Body to Cab Ground Strap ( $\frac{3}{16}$ "—24 x $\frac{3}{4}$ ") (Weapon Carrier and Gun Motor Carriage)
2	174916	Ground Strap Grounding WASHER—Steering Column and Coil to Dash	1	123461	SCREW—Body to Bumper Ground Strap Terminal (Body End) ( $\frac{1}{4}$ "—28 x $\frac{3}{4}$ ") (Ambulance)
1	120367	Ground Strap Terminal NUT—Steering Column and Coil to Dash	1	120647	SCREW—Body to Bumper Ground Strap (Bumper End) ( $\frac{3}{4}$ "—24 x 1") (Ambulance and Carry-All)
		T215 RADIO PANEL WC42	1	123461	SCREW—Body to Bumper Ground Strap Terminal (Body End) ( $\frac{1}{4}$ "—28 x 1") (Carry-All)
1	913319	GROUND STRAP—Controls	4	120706	SCREW—Hood Side Panel Grounding Plate ( $\frac{1}{4}$ "—20 x $\frac{1}{2}$ ")
1	922518	GROUND STRAP—Engine to Frame Side Rail	4	120628	SCREW—Hood Bumper—Attaching ( $\frac{1}{4}$ "—20 x $\frac{1}{2}$ ")
2	178571	Ground Strap Grounding WASHER—Engine to Frame Side Rail (Engine End)	1	120228	SCREW—Battery Support to Splash Shield Ground Strap ( $\frac{3}{16}$ "—18 x $\frac{3}{8}$ ") (Ambulance, Weapon Carrier and Gun Motor Carriage)
2	178551	Ground Strap Grounding WASHER—Engine to Frame Side Rail (Fender End)	2	132696	SCREW—Dome Lamp Switch Attaching (No. 6—32 x $\frac{3}{4}$ ") (Ambulance)
1	923719	GROUND STRAP—Engine to Dash	2	132696	SCREW—Roof Ventilator Switch—Attaching (No. 6—32 x $\frac{3}{8}$ ") (Ambulance)
2	174916	Ground Strap Grounding WASHER—Engine to Dash			<b>NUTS</b>
1	123461	Ground Strap Terminal BOLT—Engine to Dash			<b>T214 RADIO NOISE SUPPRESSION PARTS</b>
1	120367	Ground Strap Terminal NUT—Engine to Dash	4	134566	NUT—Rear Axle Drive Shaft Puller Screw ( $\frac{3}{8}$ "—16)
1	123382	Ground Strap Terminal SCREW—Engine to Dash	2	120376	NUT—Steering Column Grounding Screw ( $\frac{3}{16}$ "—18)
1	178551	Ground Strap Terminal Screw LOCKWASHER—Engine to Dash	1	120611	NUT—Ignition Coil Attaching Clamp Screw (No. 10-32)
1	923861	GROUND STRAP—Battery to Body	1	131657	NUT—Rear View Outside Mirror ( $\frac{1}{4}$ "—28)
1	178532	Ground Strap Grounding WASHER—Battery to Body	4	120367	NUT—Terminal Box Attaching Screw ( $\frac{1}{4}$ "—28) (Reconnaissance and Carry-All)
1	120368	Ground Strap Terminal NUT—Battery to Body	12	120369	NUT—Rear Axle Housing Cover Stud ( $\frac{3}{4}$ "—24)
1	923720	GROUND STRAP—Steering Column to Instrument Panel	12	120369	NUT—Drive Pinion Carrier Stud ( $\frac{3}{4}$ "—24)
1	923861	GROUND STRAP—Front Fender to Frame	2	120375	NUT—Body Cross Sill to Frame Ground Strap Screw ( $\frac{1}{4}$ "—20) (Weapon Carrier and Gun Motor Carriage)
1	870846	Ground Strap SCREW—Front Fender to Frame	1	120368	NUT—Body to Cab Ground Strap Screw (Cab End) ( $\frac{3}{16}$ "—24)
2	178551	Ground Strap Grounding WASHER—Front Fender End and (Steering Column to Instrument Panel)	1	120369	NUT—Body to Bumper Ground Strap Terminal Screw (Bumper End) ( $\frac{3}{4}$ "—24) (Ambulance and Carry-All)
1	174916	Ground Strap Grounding WASHER—Frame End	1	120367	NUT—Body to Bumper Ground Strap Terminal Screw (Body End) ( $\frac{1}{4}$ "—28) (Ambulance and Carry-All)
1	922537	GROUND STRAP—Steering Column and Coil to Dash	4	134551	NUT—Hood Side Panel Grounding Plate Screw ( $\frac{1}{4}$ "—20)
2	174916	Ground Strap Grounding WASHER—Steering Column and Coil to Dash	4	134551	NUT—Hood Bumper Attaching Screw ( $\frac{1}{4}$ "—20)
1	120367	Ground Strap Terminal NUT—Steering Column and Coil to Dash	1	120376	NUT—Battery Support to Splash Shield Ground Strap Screw ( $\frac{3}{16}$ "—18) (Ambulance, Weapon Carrier and Gun Motor Carriage)
		T214—ALL BODY STYLES	2	120369	NUT—Radiator Tie Rod to Shell Screw ( $\frac{3}{8}$ "—24)
1	923720	GROUND STRAP—Front Fender Splash Shield to Frame	4	134551	NUT—Tail Lamp Attaching ( $\frac{1}{4}$ "—20)
1	922518	GROUND STRAP—Engine to Frame—Right	8	121743	NUT—Reflector Attaching Screw (No. 12—24) (Weapon Carrier and Gun Motor Carriage)
1	925376	GROUND STRAP—Engine to Frame—Left	4	120622	NUT—Front Door Glass Frame to Lower Channel Screw (No. 8—32) (Carry-All)
1	923719	GROUND STRAP—Engine to Dash (except Ambulance)			
1	922537	GROUND STRAP—Steering Column and Coil to Dash			
1	913319	GROUND STRAP—Control Cables to Dash			
3	925385	GROUND STRAP—Hood			
		T214 RECONNAISSANCE AND RADIO BODY			
1	923720	GROUND STRAP—Steering Column to Instrument Panel			
		T214 AMBULANCE AND CARRY-ALL			
1	926123	GROUND STRAP—Steering Column to Instrument Panel			
1	923719	GROUND STRAP—Body to Bumper			
1	926053	GROUND STRAP—Battery Support to Splash Shield			
1	923720	GROUND STRAP—Engine to Dash (Ambulance only)			

: CURRENT NUMBER—FOR PREVIOUS NUMBER, SEE PARTS SUPERSEDCENCE LIST.

SNL G-657

# MISC. BODY, CHASSIS ACCESSORIES—GROUP 22

## RADIO NOISE SUPPRESSION PARTS—SUB-GROUP 2205

Quan. Req'd	Part No.	Name of Part	Quan. Req'd	Part No.	Name of Part
<b>PLAINWASHERS</b>			<b>T214 RADIO NOISE SUPPRESSION PARTS—CONT'D</b>		
		<b>T214 RADIO NOISE SUPPRESSION PARTS</b>	4	120214	LOCKWASHER—Battery Splash Shield to Hanger Bolt (3/16") (Carry-All)
2	120394	PLAINWASHER—Battery Hold-Down Cover Bolt (3/8") (Ambulance and Carry-All)	3	120214	LOCKWASHER—Battery Support Plate to Rear Fender Bolt (3/16") (Carry-All)
6	120387	PLAINWASHER—Battery Support Plate to Rear Fender Bolt (3/16") (Carry-All)	1	120214	LOCKWASHER—Battery Cover Hold-Down Clip Bolt (3/16") (Reconnaissance and Carry-All)
2	120387	PLAINWASHER—Fuel Tank Upper Filler Tube Bracket Screw (3/16") (Weapon Carrier, Gun Motor Carriage and Carry-All)	10	120214	LOCKWASHER—Battery Cover Hinge Bolt (3/16") (Carry-All)
1	120387	PLAINWASHER—Crankcase Outlet Pipe Air Cleaner Screw (3/16")	3	120214	LOCKWASHER—Fuel Tank Filler Tire Chain Shield Screw (3/16") (Weapon Carrier and Gun Motor Carriage)
1	120391	PLAINWASHER—Tube and Cable Clip (No. 10)	2	120214	LOCKWASHER—Fuel Tank Upper Filler Tube Bracket Screw (3/16") (Weapon Carrier, Gun Motor Carriage and Carry-All)
4	120395	PLAINWASHER—Seat Cushion Pan to Rear Riser Support Screw (1/16") (Weapon Carrier and Gun Motor Carriage)	1	120214	LOCKWASHER—Crankcase Ventilator Outlet Pipe Air Cleaner Screw (3/16")
1	120394	PLAINWASHER—Aircleaner Elbow Stud Nut (3/8")	1	120214	LOCKWASHER—Muffler Tail Pipe Bracket Clamp Bolt (3/16")
2	120396	PLAINWASHER—Engine Front Support Plate Screw (1/2")	2	178532	LOCKWASHER—Starting Pedal Rod Brkt. Screw (3/16")
		<b>LOCKWASHERS</b>	2	120214	LOCKWASHER—Muffler Rear Support Bracket Clamp Bolt (3/16")
		<b>T214 RADIO NOISE SUPPRESSION PARTS</b>	4	120214	LOCKWASHER—Carb. to Air Cleaner Stud Nut (3/16")
10	178532	LOCKWASHER—Oil Filter to Bracket (3/16")	5	120214	LOCKWASHER—Battery Cover Hinge to Running Board Bolt (3/16") (Reconnaissance)
8	178551	LOCKWASHER—Front Fender Splash Shield Rear Bracket Frame (3/8")	1	120214	LOCKWASHER—Crankcase Ventilator
4	178591	LOCKWASHER—on Radiator Support Bolt (1/4")	1	120382	LOCKWASHER—Muffler Tail Pipe Bracket to Frame Bolt (3/8")
4	178551	LOCKWASHER—Radiator Support Bracket to Frame Bolt (3/8")	1	120382	LOCKWASHER—Brake Tube and Hose to Frame Bolt (3/8")
2	178591	LOCKWASHER—Radiator Support Bracket to Frame Screw (1/4")	2	120382	LOCKWASHER—Starting Crank Support Bolt (3/8") (Weapon Carrier and Reconnaissance with Winch)
6	178551	LOCKWASHER—Radiator Core Support Screw (3/8")	4	120382	LOCKWASHER—Front Spring Torque Arrestor Bolt (3/8")
1	178551	LOCKWASHER—Throttle Control Mounting Nut (3/8")	2	120382	LOCKWASHER—Winch to Winch U-Bolt (3/8") (Weapon Carrier and Reconnaissance with Winch)
1	178551	LOCKWASHER—Choke Control Mounting Nut (3/8")	8	120382	LOCKWASHER—Body Hold-Down Bracket Bolt (3/8") (Ambulance)
2	178551	LOCKWASHER—Cab Hold-Down Rear Bracket Bolt (Weapon Carrier and Gun Motor Carriage) (3/8")	2	120382	LOCKWASHER—Body Hold-Down Clamp Bolt (3/8") (Reconnaissance and Carry-All)
1	178551	LOCKWASHER—Cab Hold-Down Rear Bracket (Ambulance and Carry-All) (3/8")	4	120382	LOCKWASHER—Battery Tray Bolt (3/8") (Weapon Carrier and Ambulance)
6	178591	LOCKWASHER—Cab Hold-Down Rear Bracket Bolt (3/8")	4	120382	LOCKWASHER—Rear Axle Bumper to Frame Bolt (3/8") (Except Ambulance)
4	178532	LOCKWASHER—Steering Column Grounding Bolt Nut (3/16")	12	120382	LOCKWASHER—Rear Axle Drive Shaft Stud Nut (3/8")
8	178571	LOCKWASHER—Front Fender Rear Support Frame Bracket to Frame Bolt (3/16")	1	120382	LOCKWASHER—Front Axle Brake Tube Tee (3/8")
12	178551	LOCKWASHER—Front Fender Rear Support to Frame Bracket (3/8")	2	120382	LOCKWASHER—Front Axle Housing Brake Bracket Stud (3/8")
12	178378	LOCKWASHER—Fire Extinguisher Screw (No. 10)	1	120382	LOCKWASHER—Front Brake Hose Frame Brkt. (3/8")
4	178551	LOCKWASHER—Radiator Tie Rod to Shell Bolt (3/8")	1	120382	LOCKWASHER—Air Cleaner Elbow Stud Nut (3/8")
2	178612	LOCKWASHER—Radiator Tie Rod to Dash Bracket Nut (3/16")	4	120382	LOCKWASHER—Frame Fuel Tank Support Cross-member to Frame Bolt (3/8")
10	178551	LOCKWASHER—Radiator Guard to Head Lamp Guard Nut (3/8")	4	120382	LOCKWASHER—Brake Pedal Brkt. to Frame Bolt (3/8")
4	178551	LOCKWASHER—Radiator Guard Support to Guard Bolt (with Winch) (3/8")	2	120382	LOCKWASHER—Rear Spring Front Bolt Lock Bolt (3/8")
8	178551	LOCKWASHER—Radiator Guard Support to Guard Bolt (without Winch) (3/8")	2	120382	LOCKWASHER—Muffler Brkt. Front to Frame Bolt (3/8")
2	178532	LOCKWASHER—Brake Tube Frame Tee (3/16")	4	120382	LOCKWASHER—Rear Sprng. Shkls. Bolt Lock Bolt (3/8")
8	178551	LOCKWASHER—Running Board Fastening Bolt (3/8") (Except Carry-All)	2	120382	LOCKWASHER—Battery Inner Splash Shield to Running Board Bolt (3/8") (Reconnaissance)
10	178551	LOCKWASHER—Running Board Fastening Bolt (3/8") (Carry-All)	2	120382	LOCKWASHER—Battery Inner Splash Shield to Frame Bolt (3/8") (Reconnaissance)
1	178532	LOCKWASHER—Battery Ground Cable to Generator Bracket (Weapon Carrier, Ambulance and Gun Motor Carriage) (3/16")	2	178551	LOCKWASHER—Running Board Left Front Hanger to Cab Bracket Bolt (3/8") (Except Ambulance)
1	178532	LOCKWASHER—Blackout Parking Lamp (3/16")	1	120382	LOCKWASHER—Crankcase Outlet Pipe Bracket to Cylinder Block Screw (3/8")
18	178532	LOCKWASHER—Front Floor Plate Screw (3/16")	4	178551	LOCKWASHER—Running Board Left Front Hanger to Frame Bolt (3/8") (Except Ambulance)
8	178532	LOCKWASHER—Front Floor Trans. Cover Screw (3/16")	4	120384	LOCKWASHER—Transfer Case Mounting Screw (1/2")
2	178532	LOCKWASHER—Front Floor Transmission Lubricating Hole Cover Screw (3/16")	2	120384	LOCKWASHER—Front Tow Hook Bolt (1/2")
6	178532	LOCKWASHER—Engine Dust Pan (3/16")	2	120384	LOCKWASHER—Front Shock Absorber Link Rod Anchor Bracket Bolt (1/2")
2	178551	LOCKWASHER—Clutch Pedal Bracket Screw (3/8")	2	120384	LOCKWASHER—Winch to Frame Bolt (1/2") (Weapon Carrier, Reconnaissance and Gun Motor Carriage)
3	178551	LOCKWASHER—Brake Pedal Pull-Back Spring Bracket to Frame Bolt (3/8")	2	120384	LOCKWASHER—Winch to Bumper Bolt (1/2")
2	178378	LOCKWASHER—Ignition Coil Grounding (No. 10)	2	120384	LOCKWASHER—Winch to Frame Bolt (Rear 1/2") (Weapon Carrier and Reconnaissance with Winch)
1	178378	LOCKWASHER—Starting Motor Interference Condenser Grounding (No. 10)	4	120384	LOCKWASHER—Rear Bumper Body Step Bolt (1/2") (Ambulance)
2	120380	LOCKWASHER—Front Axle Brake Tube Clip Stud (1/4")	4	120384	LOCKWASHER—Front Bumper Support Bracket to Frame Bolt (1/2")
4	120380	LOCKWASHER—Rear Axle Brake Tube Clip Stud (1/4")	2	120384	LOCKWASHER—Front Bumper Reinforcement Bracket to Frame Bolt (1/2")
As Req'd	120380	LOCKWASHER—Tube and Cable Clip Bolt and Nut (1/4")	2	120384	LOCKWASHER—Front Bumper Reinforcement Bracket to Spring Bracket (1/2")
2	120214	LOCKWASHER—Oil Can Bracket Bolt (3/16")	2	120384	LOCKWASHER—Engine Front Support Plate Screw (1/2")
4	120214	LOCKWASHER—Fan Blade Screw (3/16")	2	120384	



# MISC. BODY, CHASSIS ACCESSORIES — GROUP 22

## RADIO NOISE SUPPRESSION PARTS—SUB-GROUP 2205

Quan. Req'd	Part No.	Name of Part	Quan. Req'd	Part No.	Name of Part
T214 RADIO NOISE SUPPRESSION PARTS—CONT'D			T214 RADIO NOISE SUPPRESSION PARTS—CONT'D		
2	120384	LOCKWASHER—Front Bumper to Frame Bolt (1/4")	6	178532	LOCKWASHER—Battery Support Plate to Rear Fender Bolt (5/16") (Carry-All)
4	120384	LOCKWASHER—Front Bumper Reinforcement Bracket to Bumper Bolt (1/4")	4	178532	LOCKWASHER—Battery Inner Splash Shield to Hanger Bolt (5/16") (Carry-All)
4	120384	LOCKWASHER—Tire Carrier Support Bracket to Frame Bolt (1/4") (Except Ambulance)	2	178591	LOCKWASHER—Battery Hold-Down Cover Bolt (1/2") (Weapon Carrier and Ambulance)
2	120384	LOCKWASHER—Muffler Rear Support Bracket to Frame Bolt (1/4")	2	178551	LOCKWASHER—Battery Hold-Down Cover Bolt (3/8") (Weapon Carrier and Ambulance)
2	120214	LOCKWASHER—Rear Shock Abs'r Link Rod Pin (5/16")	3	178551	LOCKWASHER—Generator to Regulator Wiring Clip (3/8") (Weapon Carrier, Amb. and Gun Mtr. Carriage)
1	121753	LOCKWASHER—Frame Trailer Connector Ground Wire (No. 14—1/4") (Except Ambulance)	1	178591	LOCKWASHER—Battery Tray to Frame Ground Strap (1/4") (Weapon Carrier, Amb. and Gun Mtr. Carriage)
3	138489	LOCKWASHER—Master Cyl. Attaching Screw (3/8")	1	174916	LOCKWASHER—Terminal Box Condenser Screw (1/4") (Carry-All)
2	138489	LOCKWASHER—Battery Hold-Down Cover Bolt (3/8") (Weapon Carrier and Gun Motor Carriage)	2	174916	LOCKWASHER—Terminal Box Condenser Screw (1/4") (Reconnaissance)
2	135629	LOCKWASHER—Rear Shock Absorber Link Rod and Eye Bolt (1/4")	2	178551	LOCKWASHER—Running Board Left Front Hanger to Cab Bracket Bolt (3/8")
1	120217	LOCKWASHER—Ignition Coil Mounting Clamp Screw	6	178551	LOCKWASHER—Running Board Left Front Hanger to Frame Bolt (3/8")
4	120217	LOCKWASHER—Defroster Nozzle Mounting Screw (No. 10) (Ambulance)	8	178551	LOCKWASHER—Running Board Hanger Bolt Nut—Upper (3/4") (Ambulance and Carry-All)
8	121744	LOCKWASHER—Reflector Attaching Screw (No. 12) (Weapon Carrier and Gun Motor Carriage)	8	178591	LOCKWASHER—Running Board Hanger Bolt Nut—Lower (1/2")
2	174916	LOCKWASHER—Left Front Splash Shield to Frame Ground Strap Bolt (1/4")	12	174916	LOCKWASHER—Tube and Cable Clip Screw Nut (1/4")
1	178551	LOCKWASHER—Left Front Splash Shield to Frame Ground Strap Grounding Washer (3/8")	1	120217	LOCKWASHER—Ignition Distributor Filter Terminal Screw (No. 10)
4	178591	LOCKWASHER—Body Cross Sill to Frame Grounding Strap (1/2") (Weapon Carrier and Gun Motor Carriage)	8	120898	LOCKWASHER—Rear Spring Clip Nut
4	178551	LOCKWASHER—Fuel Filter Mounting Bolt (3/8")	8	120898	LOCKWASHER—Front Spring Clip Nut
2	178532	LOCKWASHER—Starter Pedal Bracket Screw (3/8")	2	178571	LOCKWASHER—Oil Filter Bracket to Cylinder Head Grounding (1/16")
1	120380	LOCKWASHER—Rear View Outside Mirror (1/4")	1	174916	LOCKWASHER—Terminal Box Condenser Screw (1/4") (Carry-All)
4	174916	LOCKWASHER—Hood Side Panel Grounding Plate Bolt Nut (1/4")	2	174916	LOCKWASHER—Terminal Box Condenser Screw (1/4") (Reconnaissance)
8	174916	LOCKWASHER—Hood Bumper Attach. Bolt Nut (1/4")	12	174916	LOCKWASHER—Tube and Cable Clip Nut (1/4")
2	178551	LOCKWASHER—Battery Cover Hold-Down Bolt (3/8")	4	120383	LOCKWASHER—Seat Cushion Pan to Rear Riser Support Screw (3/16") (Weapon Carrier and Gun Mtr. Car.)
2	178591	LOCKWASHER—Battery Cover Hold-Down Bolt (1/2") (Weapon Carrier, Ambulance and Gun Motor Carriage)	1	121753	LOCKWASHER—Carburetor Throttle Return Spring Nut (Dash End) (No. 14—1/4")
1	138485	LOCKWASHER—Battery Cover Hold-Down Bolt (3/16")	1	178532	LOCKWASHER—Body to Cab Ground Strap Bolt (5/16") (Weapon Carrier and Gun Motor Carriage)
3	178532	LOCKWASHER—Battery Support to Splash Shield Ground Strap Bolt (5/16") (Weapon Carrier, Ambulance and Gun Motor Carriage)	3	178551	LOCKWASHER—Body to Bumper Ground Strap (3/8") (Ambulance and Carry-All)
4	178532	LOCKWASHER—Rear View Mirror Arm to Cowl Screw (3/16")	3	174916	LOCKWASHER—Body to Bumper Ground Strap (1/4") (Ambulance and Carry-All)
1	178591	LOCKWASHER—Engine Fr. Support Plate Screw (1/4")	<b>COTTER PINS</b>		
1	178378	LOCKWASHER—Generator Ground Screw (No. 10)	T214 RADIO NOISE SUPPRESSION PARTS		
4	178551	LOCKWASHER—Battery Tray Bolt (3/8")	3	121222	COTTER PIN—Body Hold-Down Screw (3/16" x 3/4") (Weapon Carrier and Gun Motor Gun Carriage)
2	178571	LOCKWASHER—Side Antenna Brush Guard Screw (3/16") (Carry-All)	2	121222	COTTER PIN—Auxiliary Seat to U Body Support Pin (3/16" x 3/4") (Carry-All)
4	178551	LOCKWASHER—Rear Fender Battery Cover Hold-Down Bracket Screw (3/8") (Carry-All)	1	137159	COTTER PIN—Accelerator Shaft to Throttle Control Bellcrank Rod (3/16" x 3/8")
10	178532	LOCKWASHER—Battery Cover Hinge to Running Board Bolt (5/16") (Reconnaissance)	<b>MISCELLANEOUS PARTS</b>		
2	178532	LOCKWASHER—Battery Cover Hold-Down Clip Bolt (5/16") (Reconnaissance)	T214 RADIO NOISE SUPPRESSION PARTS		
2	178551	LOCKWASHER—Battery Hold-Down Clamp Bolt (3/8") (Reconnaissance and Carry-All)	2	925272	Hood BUMPER Assembly
2	178551	LOCKWASHER—Battery Inner Splash Shield to Frame Bolt (3/8") (Reconnaissance)	1	926059	Ignition Cable TUBE and BRACKET Assembly
2	178551	LOCKWASHER—Battery Inner Splash Shield to Running Board Bolt (3/8") (Reconnaissance)	1	640725	Cylinder Head STUD
20	178532	LOCKWASHER—Battery Cover Hinge Bolt Nut (3/16") (Carry-All)	1	927110	Battery Terminal CONDENSER
1	178532	LOCKWASHER—Battery Hold-Down Clip Bolt (3/16") (Carry-All)	1	644073	Generator to Regulator Cable CLIP (at Generator)
1	178532	LOCKWASHER—Battery Cover Hold-Down Screw (3/16") (Carry-All)	1	644073	Gen. to Reg. Cable CLIP (at Battery Hold-Down Bolt)
2	178551	LOCKWASHER—Battery Cover Hold-Down Clamp Bolt (3/8") (Carry-All)			

# MISC. BODY, CHASSIS ACCESSORIES—GROUP 22

## RADIO NOISE SUPPRESSION PARTS—SUB-GROUP 2205 PARTS PECULIAR TO MODEL T223

NO. REQ.	PART NO.	PART NAME	LOCATION OF PART
1	923719	GROUND STRAP	Engine to Dash
1	174916	WASHER	Engine to Dash Ground Strap Grounding
1	870846	BOLT	Engine to Dash Ground Strap Terminal
1	123382	SCREW	Engine to Dash Ground Strap Terminal
1	178551	LOCKWASHER	Engine to Dash Ground Strap Terminal Screw
1	925376	GROUND STRAP	Engine to Frame
2	178551	WASHER	Engine to Frame Ground Strap Terminal Bolt Grounding
2	178571	WASHER	Engine to Frame Ground Strap Grounding
1	922518	GROUND STRAP	Engine to Right Side Rail
1	923720	GROUND STRAP	Steering Column to Instrument Panel
1	178551	LOCKWASHER	Steering Column to Instrument Panel Ground Strap Grounding
1	923861	GROUND STRAP	Steering Column and Coil to Dash
4	174916	LOCKWASHER	Ignition Coil Mounting Bolt Grounding
1	870846	SCREW	Steering Column and Coil to Dash Ground Strap
1	174916	WASHER	Steering Column and Coil to Dash Ground Strap Grounding
1	926106	CONDENSER	Starter Assy.
2	178378	LOCKWASHER	Starter Condenser Grounding
1	923840	FILTER	Generator Regulator Field Terminal Assy.
1	131375	SCREW	Generator Regulator Field Terminal Filter Terminal
1	120380	LOCKWASHER	Generator Regulator Field Terminal Filter Terminal Screw
1	134551	NUT	Generator Regulator Field Terminal Filter Terminal
1	120380	LOCKWASHER	Generator Regulator Field Terminal Filter Terminal Nut
1	924715	FILTER	Radio Interference Assy.
6	132900	SCREW	Radio Interference Filter Terminal
6	120217	LOCKWASHER	Radio Interference Filter Terminal Screw
4	120368	NUT	Radio Interference Filter Mounting
8	178532	LOCKWASHER	Radio Interference Filter Mounting Nut
1	918157	SUPPRESSOR	Radio Ignition Dist. Interference
1	924693	GROUND STRAP	Body to Bumperette
1	120367	NUT	Body to Bumperette Ground Strap Terminal Bolt
1	926053	GROUND STRAP	Battery Support to Splash Shield
1	926123	GROUND STRAP	Front Fender Splash Shield to Frame
3	925385	GROUND STRAP	Hood

# MISC. BODY, CHASSIS ACCESSORIES—GROUP 22

## MODEL T214 WEAPON CARRIER CONVERSION PACKAGE—SUB-GROUP 2206

Quan. Req'd	Part No.	Name of Part
The following package contains all parts necessary to convert a Quarter-master Weapon Carrier into a 37 mm Gun Motor Carriage M-6.		
1	996402	Weapon Carrier CONVERSION PACKAGE

## MODEL T214 GUN MOUNTING PARTS—SUB-GROUP 2207

Quan. Req'd	Part No.	Name of Part
12	124169	Gun Pedestal—to Floor BOLT
12	120384	Gun Pedestal—to Floor Bolt LOCKWASHER
14	124180	Gun Pedestal—to Frame BOLT
14	120371	Gun Pedestal—to Frame Bolt NUT
14	120384	Gun Pedestal—to Frame Bolt Nut LOCKWASHER
2	991793	Gun Pedestal—Floor REINFORCEMENT
4	120392	Gun Pedestal—Floor Reinforcement PLAINWASHER

## OIL CAN BRACKET

## MODELS T211—T215—T118—T214—SUB-GROUP 2210

Quan. Req'd	Part No.	Name of Part
1	918566	Oil Can BRACKET
2	123473	Oil Can Bracket—BOLT
2	120368	Oil Can Bracket Bolt—NUT
2	120214	Oil Can Bracket Bolt—LOCKWASHER



# MISC. BODY, CHASSIS ACCESSORIES — GROUP 22

## RIFLE BRACKET ASSEMBLY AND PARTS

### SUB-GROUP 2206

MODEL T214—BUCKET SEAT COMMAND OR RECONNAISSANCE,  
TELEPHONE MAINTENANCE

### MODEL T223—PERSONNEL AND CARGO

NO. REQ.	PART NO.	NAME
1	931165	Rifle BRACKET Assembly
2	120741	Rifle Bracket SCREW
1	120368	Rifle Bracket NUT
3	178532	Rifle Bracket LOCKWASHER

Part No.	Part Name	Qty
931165	Rifle BRACKET Assembly	1
120741	Rifle Bracket SCREW	2
120368	Rifle Bracket NUT	1
178532	Rifle Bracket LOCKWASHER	3

Part No.	Part Name	Qty
931165	Rifle BRACKET Assembly	1
120741	Rifle Bracket SCREW	2
120368	Rifle Bracket NUT	1
178532	Rifle Bracket LOCKWASHER	3